

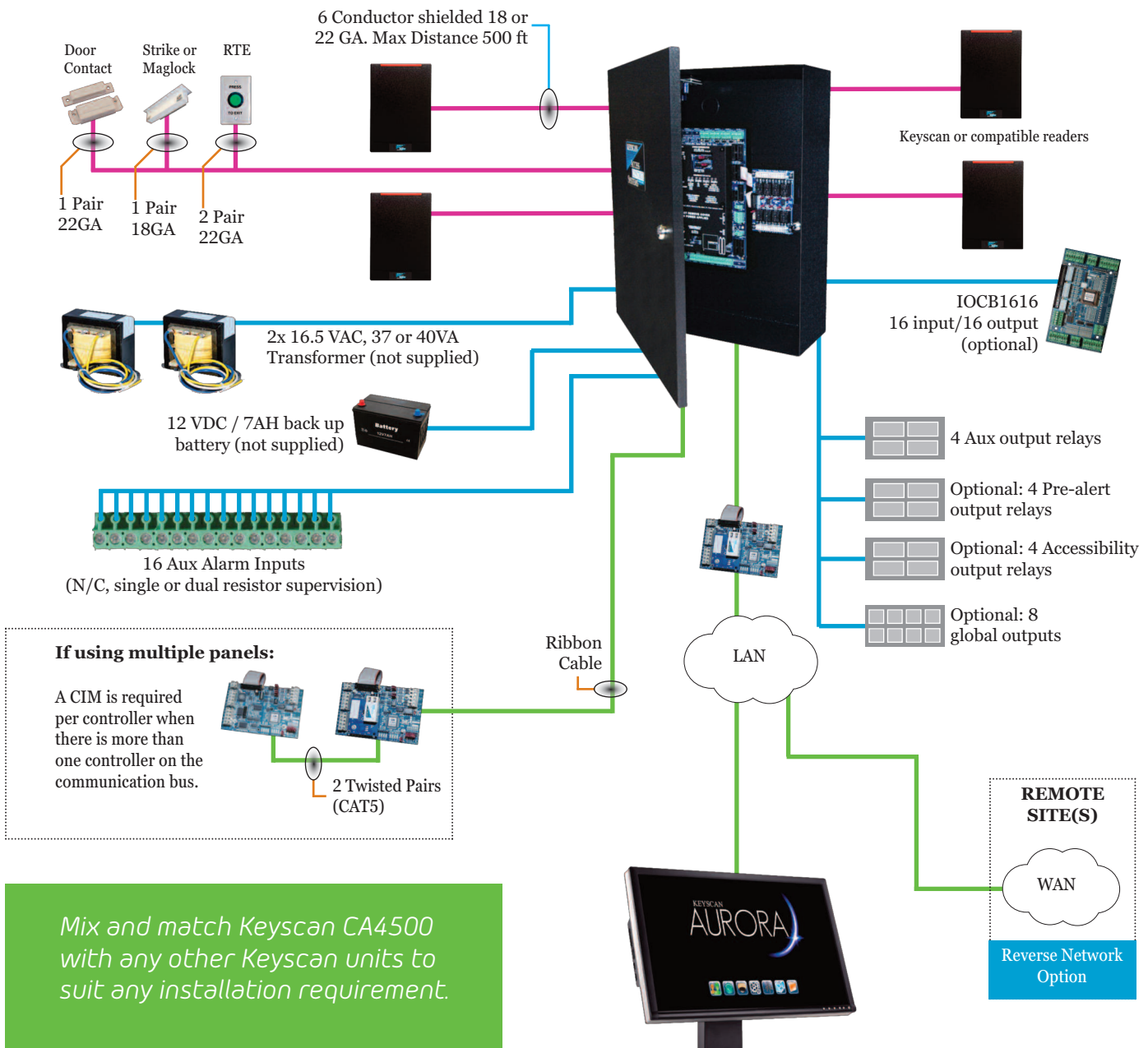





# Keyscan CA4500

## 4-Reader Access Control Unit



	CA150	CA250	CA4500	CA8500	EC1500	EC2500
<b>Keyscan Access Control Unit</b>						
Doors/Elevator Floors Supported	1 door	2 doors	4 doors	8 doors	1 cab (40 flrs)	2 cabs (16 flrs)
Reader Ports	2 (in/out)	2	4	8	1	2
Multi ACU Compatibility	Yes (Ethernet)	Yes	Yes	Yes	Yes	Yes
System Status LEDs	Yes	Yes	Yes	Yes	Yes	Yes
Dual Processors	Yes	Yes	Yes	Yes	Yes	Yes
Flash Memory	Yes	Yes	Yes	Yes	Yes	Yes
Power Fail Output	NA	Yes	Yes	Yes	Yes	Yes
Floor Monitor Inputs (supervised)	NA	NA	NA	NA	Yes	Yes
<b>Inputs</b>						
Request to Exit (RTE) Inputs (supervised)	1	2	4	8	NA	NA
Door Contact Inputs	1	2	4	8	NA	NA
Auxiliary Inputs (supervised)	2	8	16	16	NA	NA
I/O Input Expansion	NA	NA	64	64	NA	NA
<b>Outputs</b>						
Auxiliary Output Relays	1	2	4	8	NA	NA
Expansion Auxiliary Output Relays	NA	NA	8	8	NA	NA
I/O Outputs	NA	NA	64	64	NA	NA
Door Output Relays	1	2	4	8	NA	NA
<b>Capacity</b>						
No. of Credential-holders	45,000 (90,000*)	45,000 (90,000*)	45,000 (90,000*)	45,000 (90,000*)	45,000 (90,000*)	45,000 (90,000*)
Transaction File Buffer	6000	6000	6000	6000	6000	6000
Time Zones	256	256	256	256	256	256
Time Schedules	512	512	512	512	512	512
Group Levels	511	511	511	511	511	511
Holiday Dates	64	64	64	64	64	64
<b>Connectivity</b>						
Ethernet Ready	Equipped	Optional	Optional	Optional	Optional	Optional
PoE - Power over Ethernet† (IEEE 802.3af)	Equipped	NA	NA	NA	NA	NA
Global Integration	Network/Server Dependant	Capable (CIM Required)	Capable (CIM Required)	Capable (CIM Required)	Capable (CIM Required)	Capable (CIM Required)
CMAC Reverse IP	Equipped	Optional	Optional	Optional	Optional	Optional
Serial Communication	Yes	Yes	Yes	Yes	Yes	Yes

Electronic Access & Data (EAD)  
 Keyscan Inc.  
 901 Burns St., E., Whitby, Ontario  
 Canada L1N 0E6

1 888 539-7226 | [www.keyscaan.ca](http://www.keyscaan.ca)

KKT2011 2016-05

© Keyscan Inc. (2016). Information on this sheet is intended for general use only. Keyscan reserves the right to alter designs and specifications without notice or obligation. \*Special order hardware. †POE under license with Chrimar Systems Inc., US Patents 8,155,012 - 8,942,107 - 9,049,019. Printed in Canada.